

OFFSET OPENINGS
(AS SHOWN)

GRATE

WEIGHT: 266 LBS.

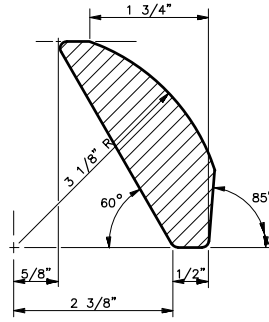

DETAIL "A"

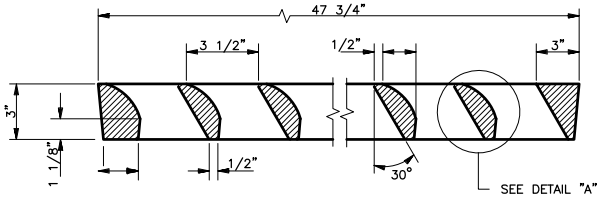

SECTION A-A

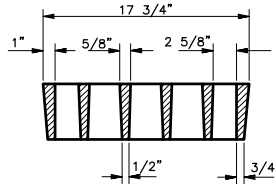

SECTION B-B

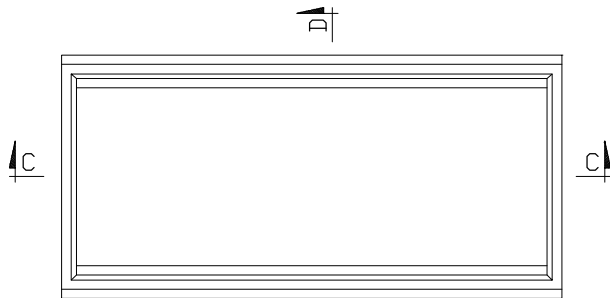

FRAME

WEIGHT: 160 LBS.

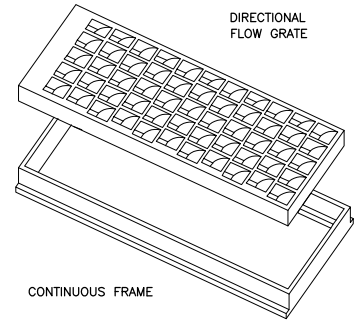

CONTINUOUS FRAME

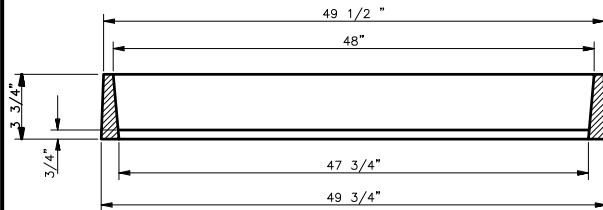

SECTION C-C

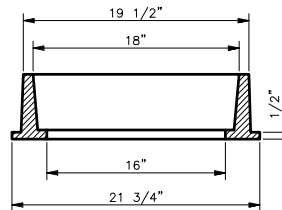

SECTION D-D

GENERAL NOTES

1. ALL DIMENSIONS ARE INCHES (in) UNLESS OTHERWISE NOTED.
2. GRATE AND FRAME MAY BE FURNISHED IN EITHER DUCTILE IRON (ASTM A-536 GRADE 60) OR CAST GRAY IRON: AASHTO M-105, CLASS 30 B (ASTM A-48).
3. INSTALLATION REQUIRES SUPPORT UNDER LONGITUDINAL AXIS OF FRAME. ORIENT GRATE WITH DIRECTION OF FLOW.

DESIGN DATA

MS 18 (HS-20) OR INTERSTATE ALTERNATE LOADING IN ACCORDANCE WITH CURRENT AASHTO AND INTERIM SPECIFICATIONS.

DUCTILE IRON AND STRUCTURAL STEEL: f_y 138 MPa.

06/08

GRATE & FRAME

HEBER CITY
STANDARD DRAWING
STORM DRAIN - 2